

# HAUNTED LAMP

## INSTALLATION AND OPERATING INSTRUCTIONS

KEEP ALL PLASTIC AND WIRE PARTS AWAY FROM CHILDREN

### PARTS

1. LAMP BASE
2. LAMP SHADE
3. LIGHTING MODULE

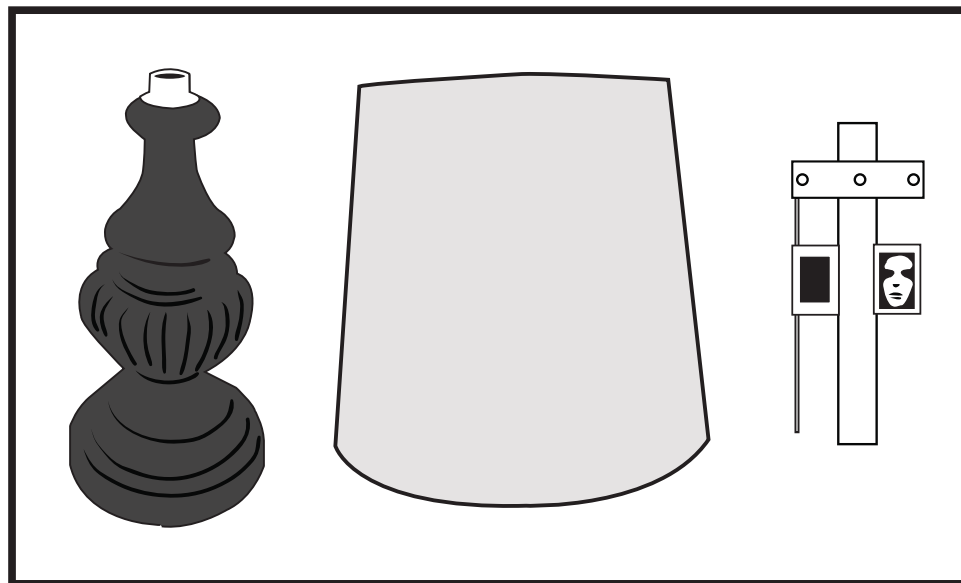

1. Insert **LIGHTING MODULE** into **LAMP BASE**. Line up groove on **LAMP BASE** and firmly insert to secure.
2. Insert **LAMP SHADE** into **LIGHTING MODULE**. Twist to lock.
3. Insert brand new "AA" Alkaline batteries into the battery compartment located on the bottom of the **LAMP BASE**.
4. Gently pull string on **LIGHTING MODULE** to turn on light.
5. To operate in Sound/Motion activation mode, make a loud sound (clap) or move in front of item to activate the scary sequence.

**Note:** Gently pull string again to turn lamp into OFF position when not in use.

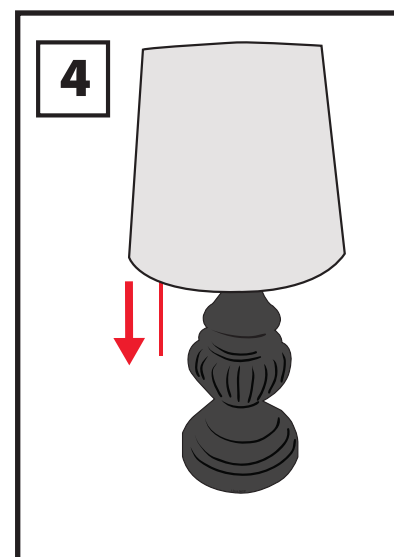
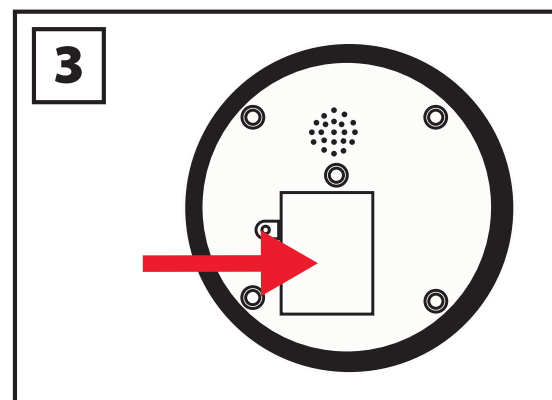
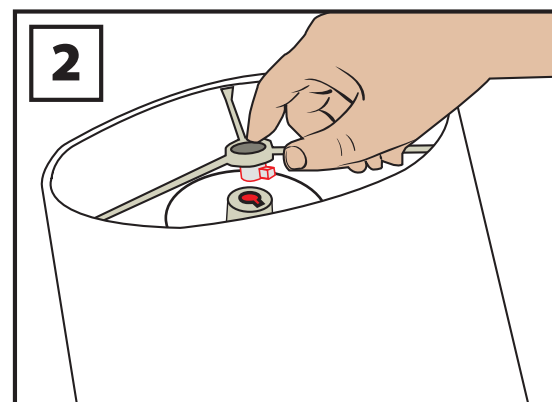
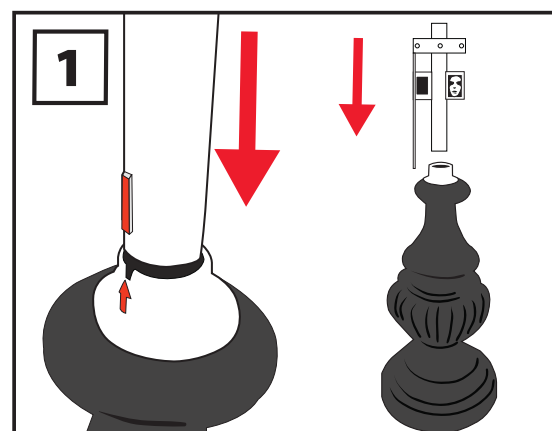

**WARNING**  
DO NOT TURN ITEM ON UNTIL YOU HAVE COMPLETELY FINISHED ASSEMBLY.  
STAY CLEAR OF ITEM WHILE OPERATING.  
DO NOT PLACE ITEM ON UNEVEN GROUND.  
DO NOT PLACE WEIGHT ON ITEM WHILE IN OPERATION



VISIT US AT [TEKKYTOYS.COM](http://TEKKYTOYS.COM)

Requires 3 'AA' Batteries sold separately.

**Surface washable only.**

ALL NEW MATERIALS:  
PLASTIC, POLYESTER,  
POLYESTER FIBER

HAUNTED LAMP

is a trademark of Tekky Toys.

Copyright © 2014 Tekky Toys.

All Rights Reserved.

Made in China



**DO NOT RETURN THIS ITEM TO THE STORE!**

If experiencing technical difficulties, please go to [www.tekkytoys.com](http://www.tekkytoys.com) for assistance.

Tekky Toys Hours of Operation: Monday - Friday 9am to 5pm CST

T: 708-478-8424 a: [support@tekkytoys.com](mailto:support@tekkytoys.com)

visit us: [tekkytoys.com](http://tekkytoys.com)