

RISING FROM THE GRAVE GHOUL

INSTALLATION AND OPERATING INSTRUCTIONS

KEEP ALL PLASTIC AND WIRE PARTS AWAY FROM CHILDREN

SMART PHONE SCAN
SETUP VIDEO

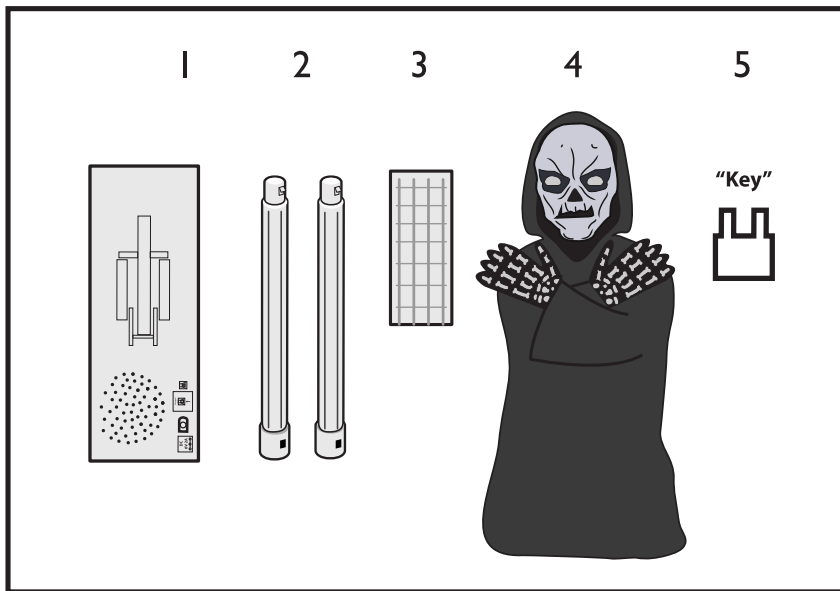

- Parts**
1. MODULE
 2. POLES
 3. FOOT
 4. BODY
 5. FOOT REMOVAL KEY

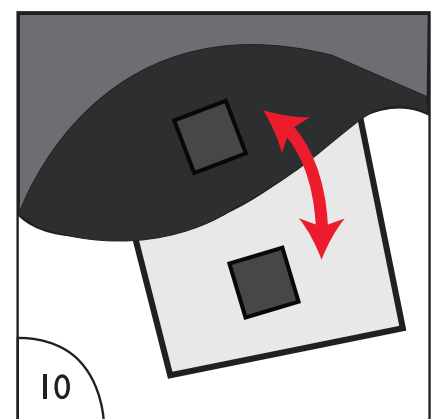
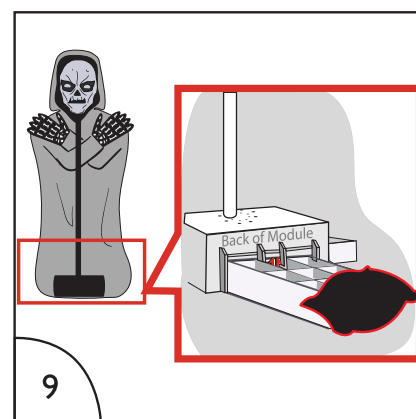
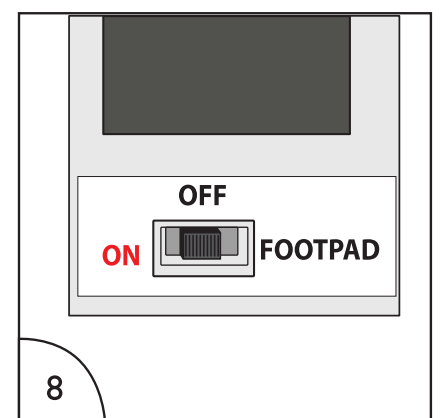
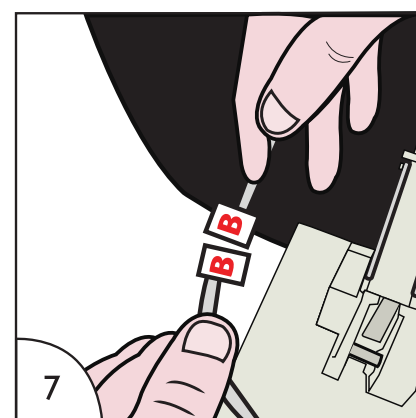
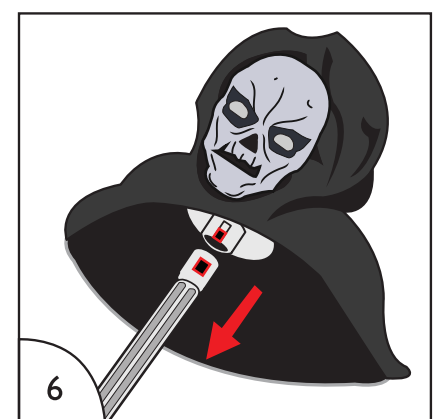
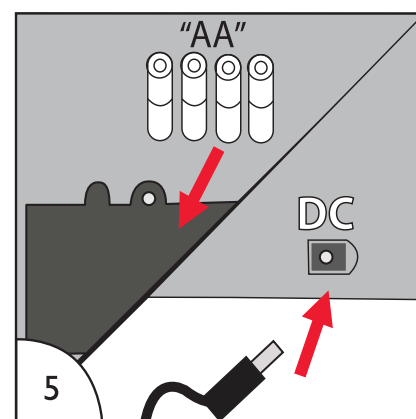
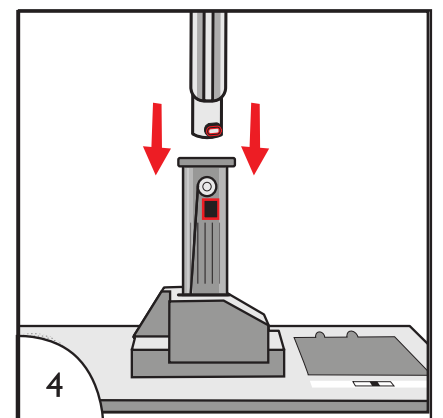
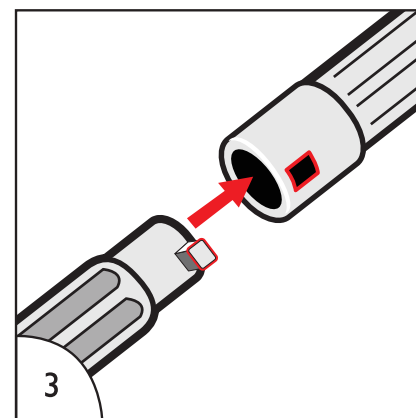
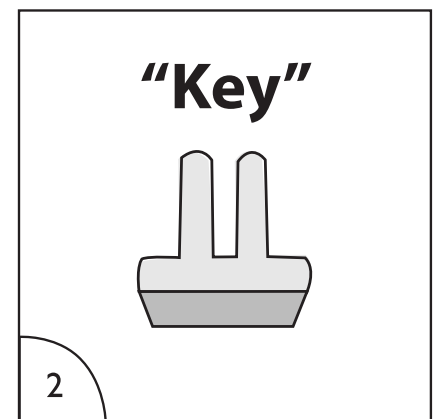
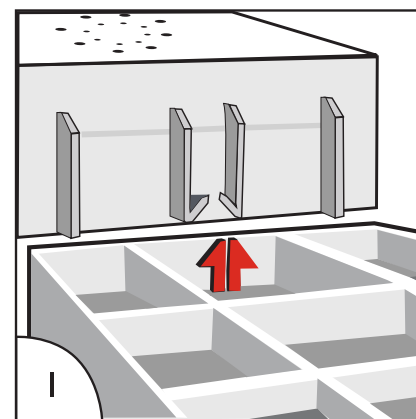

1. Insert FOOT into the bottom of the MODULE. (Match A to A)
2. Note: Press to make sure each FOOT is flush with rectangular base. To remove FOOT, insert plastic "KEY" (included) into holes on bottom to release locks, twist and pull.
3. Connect POLES together.
4. Insert POLES into receptacle on MODULE. Note: Adjust and align the snap lock with the indentation inside the pole.
5. Connect 6V2A adapter or insert 4 AA alkaline batteries into the battery compartment located on the top of the MODULE.
6. Pulling the fabric up connect BODY to the top of the POLES.
7. Connect wire located inside fabric to wire located on MODULE. (Match B to B)
8. Turn switch on top of MODULE to ON to operate in Sound activation mode. Make a loud sound (clap) to activate. Leave switch in OFF position when not in use.
9. Drape fabric down over POLES and MODULE. Completely cover the the MODULE to enhance the appearance of the Ghoul. Note: Place a weight on the FOOT to increase item stability.
10. Attach hook and loop fasteners on back of fabric to hook and loop fasteners on FOOT. Attach hook and loop fasteners on front of fabric to hook and loop fasteners on front of MODULE.

Optional Footpad Setup

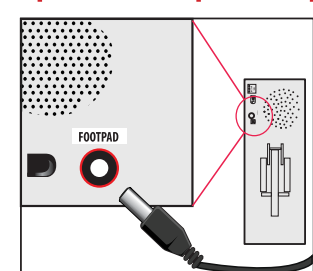

- Follow steps #1 through 7 on initial installation first.
1. Connect the cable from the optional footpad to the jack labeled FOOTPAD located on the MODULE.
 2. Place the switch on the MODULE into the 'FOOTPAD' position to enable FOOTPAD activation.
 3. Step on FOOTPAD to activate the scary sequence. (go to instruction #9 to continue setup)
- *Footpads are sold separately and can be purchased at www.tekkyaccessories.com

FOR FOOTPADS, ADAPTERS, AND ALL OTHER ACCESSORIES, PLEASE VISIT: www.tekkyaccessories.com

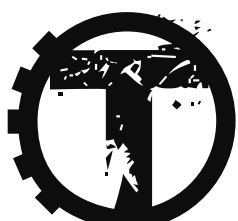

TEKKY
www.tekkydesign.com

Surface Washable Only.

ALL NEW MATERIALS :
POLYESTER, POLYURETHANE FOAM

Requires 4 'AA' Batteries (Not included)
or 6V 2A DC adapter (sold separately)

RISING FROM THE GRAVE GHOUL is a trademark of Tekky.
Copyright © 2016 Tekky. All Rights Reserved.
MADE IN CHINA

Outdoor Warning

For best overall performance, we recommend you operate your item in a sheltered outdoor area. We also recommend you bring your item indoors during adverse weather conditions (extreme cold, strong winds and/or rain). This item operates best outdoors in temperatures above freezing (32°F).

Battery Instructions and Cautions

- Use only the batteries recommended by the manufacturer. • Remove batteries when not in use.
- Do NOT use rechargeable batteries. • Be sure to insert the batteries with the correct polarity +/-.
- Never mix different types of batteries: old and new, carbon-zinc, alkaline, nickel-cadmium or rechargeable.
- Always dispose of exhausted batteries properly. Do NOT dispose of batteries in fire, they may leak or explode. ADULT SUPERVISION RECOMMENDED WHEN CHANGING BATTERIES.

Warning! This item is not a toy. For decoration only. Small parts, choking hazard.
This product is intended for use by persons 15 years of age and older.
Not intended for use by children ages 14 and under.

WARNING

DO NOT TURN ITEM ON UNTIL YOU HAVE COMPLETELY FINISHED ASSEMBLY. STAY CLEAR OF ITEM WHILE OPERATING. DO NOT PLACE ITEM ON UNEVEN GROUND. DO NOT PLACE WEIGHT ON ITEM WHILE IN OPERATION

Battery Diagram

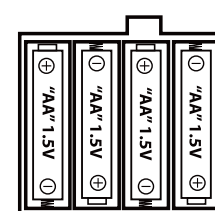

DO NOT RETURN THIS ITEM TO THE STORE!
If experiencing technical difficulties, please go to tekkydesign.com for assistance.

